

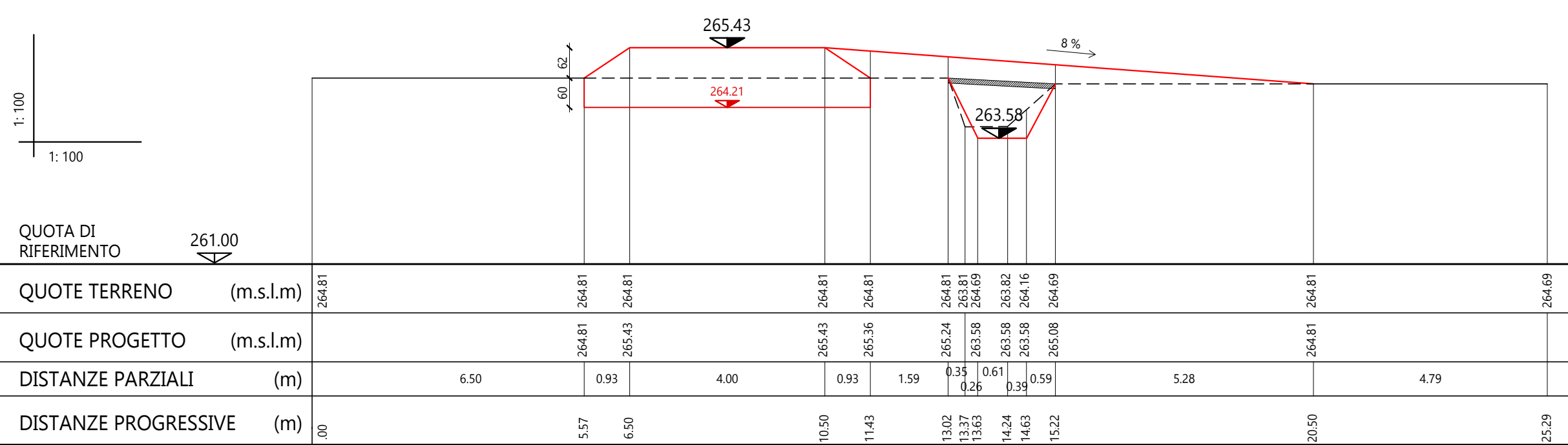

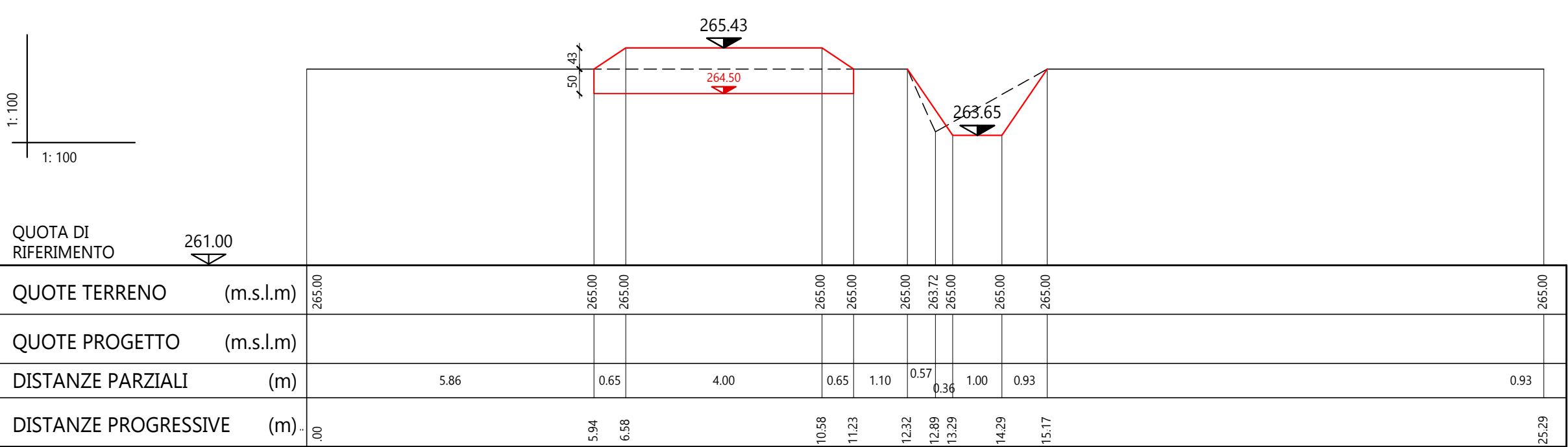









## PRG. 892.25 m



## PRG. 942.20 m



---

- |   |   |
|---|---|
|  | RETICOLOGO IDROGRAFICO ESISTENTE A CIELO APERTO                               |
|  | RETICOLOGO IDROGRAFICO ESISTENTE INTERRATO                                    |
|  | QUOTE RILIEVO ESISTENTE   |
|  | QUOTE DI PROGETTO   |
|  | CANALE IN PROGETTO O CANALE ESISTENTE RISAGOMATO                              |
|  | RILEVATO ARGINALE IN TERRE SCIOLTE IN PROGETTO - tipologico A                 |
|  | RILEVATO ARGINALE IN TERRE SCIOLTE IN PROGETTO - tipologico B                 |
|  | RILEVATO ARGINALE IN TERRE ARMATE IN PROGETTO - tipologico C                  |
|  | MANUFATTI IN PROGETTO   |
|  | OPERE "LOTTO 1" OPERE DI PRIMO LOTTO - CANALE GANDALOGGIO / FOSSO DEI PASCOLI |
|  | CANALI IN PROGETTO NON PREVISTI NEL FINANZIAMENTO                             |
|  | MANUFATTI IN PROGETTO NON PREVISTI NEL FINANZIAMENTO                          |

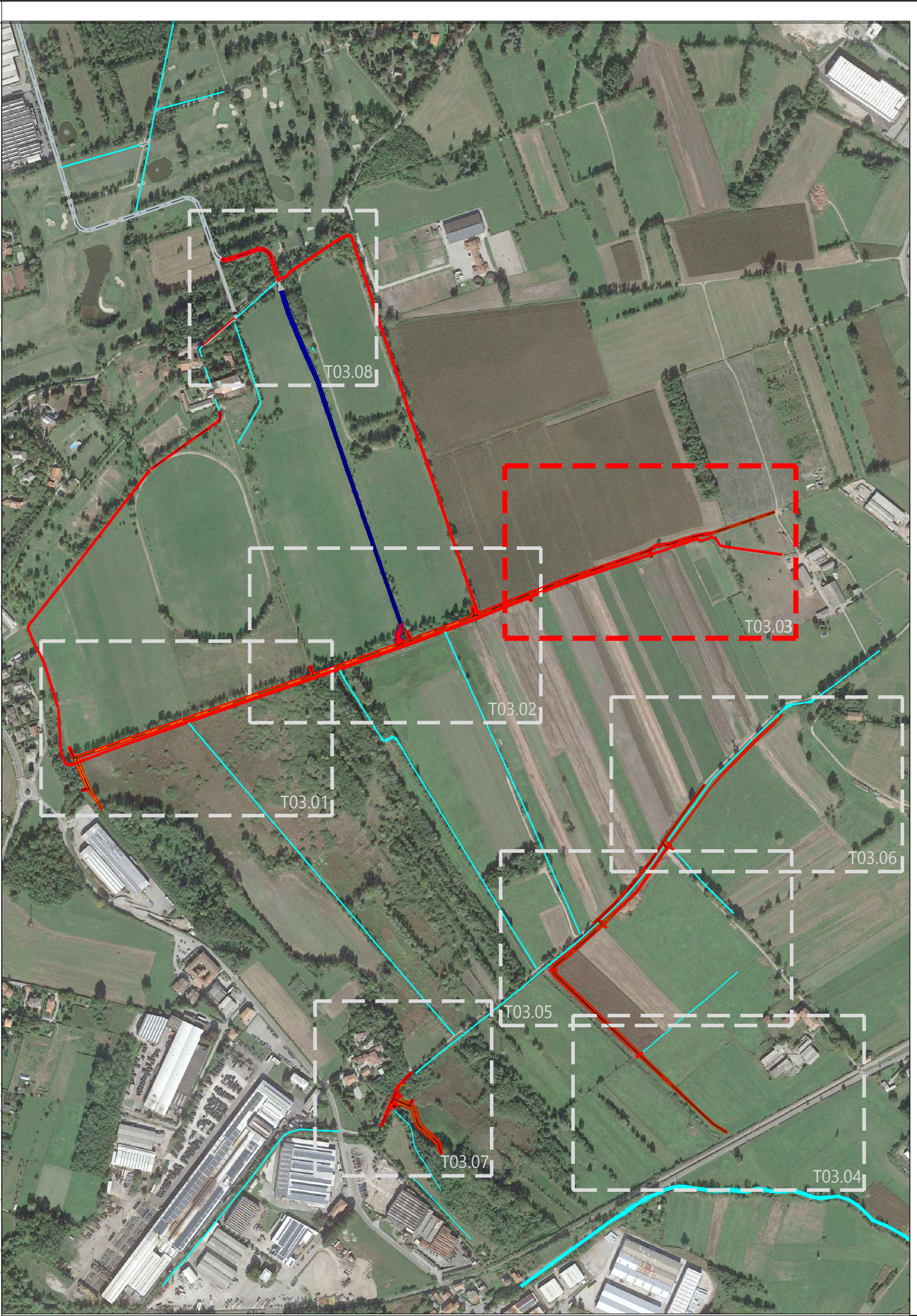
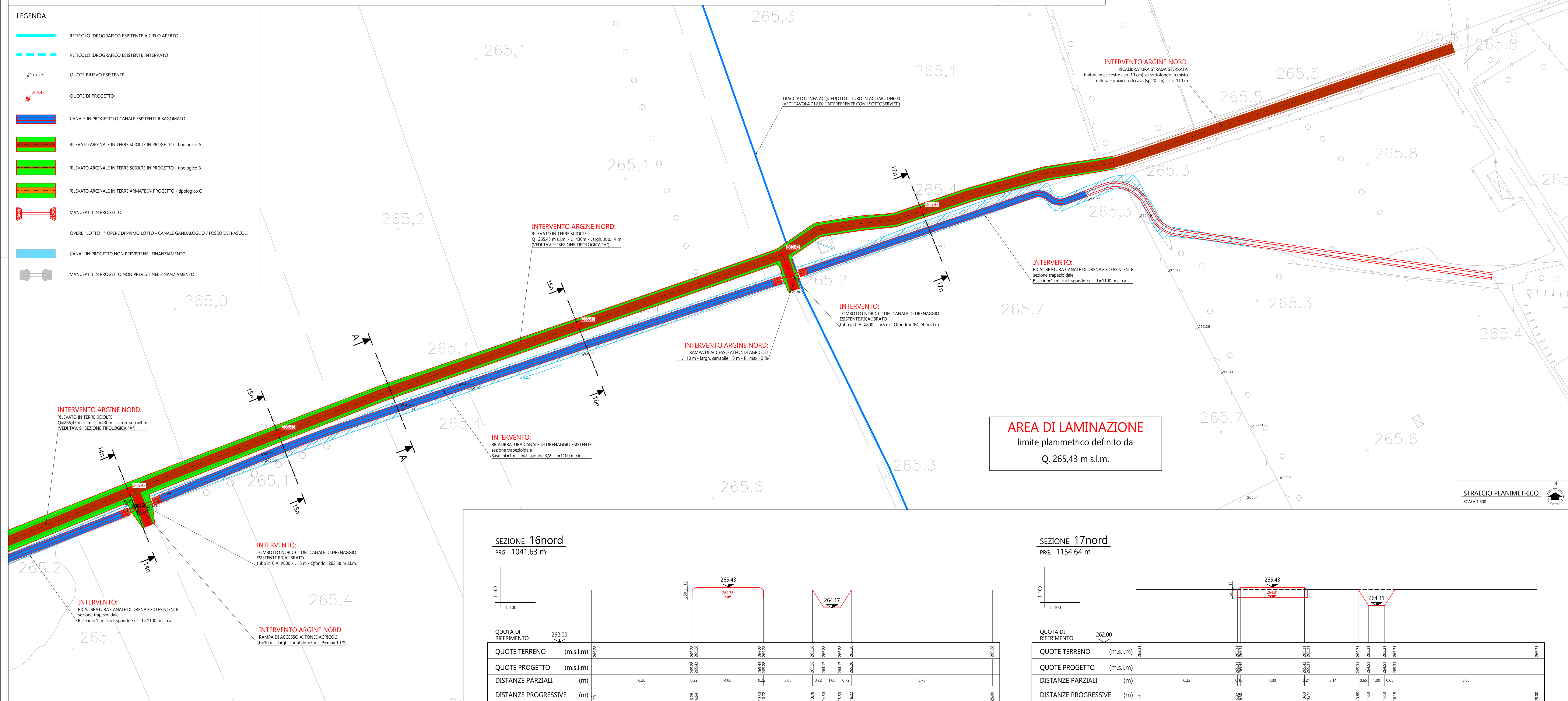

COMUNE DI  
ANNONE DI BRIANZA



Regione Lombardia



COMUNE DI  
SIRONE

OGGIONO

AREA DI LAMINAZIONE DELLE PIENE DEL TORRENTE  
GANDALOGGIO E ALTRI NEI COMUNI DI OGGIONO, SIRONE  
E ANNONE (LC)

PROGETTO ESECUTIVO



PROGETTAZIONE E CONSULENZA



ABBA.SOLUTIONS Scarl  
Via Cavour 80 - 20833 Giussano (MB)  
web: [www.abba.solutions](http://www.abba.solutions)  
mail: [info@abba.solutions](mailto:info@abba.solutions)  
pec: [abba.solutions@pec.it](mailto:abba.solutions@pec.it)

PROGETTISTI / GRUPPO DI LAVORO

Ing. Daniele Giuffrè  
Ing. Stefano Minà  
Ing. Marco Pozzoli  
Ing. Chiarangela Pereg  
Ing. Chiara Vellani  
Ing. Maria Teresa Olme  
Arch. Carla Galbiati

Ing. Chiarangela Pereg

REVISIONATO

DESCRIZIONE	Ing. Stefano Minà	Ing.
<b>PLANIMETRIA DI PROGETTO SCALA 1:500</b> foglio 3/8		

DATA

Aprile 2020	INDICAZIONE
-------------	-------------

REVISIONE	DATA
-----------	------

1	Dicembre 2017
---	---------------

RIFERIMENTO EMISSIONE / REVISIONE

Revisione a seguito di verifica progetto es

ATO	
-----	--

T03.03